

For details of longer walking routes from the park please visit [www.darwinforest.co.uk/walking](http://www.darwinforest.co.uk/walking)

Please adhere to the countryside code.

# Walks on the Park

Our flat circular walking routes are set within the natural landscape of the forest and park. The majority are gravel or stoned paths and may be uneven in places. The blue route is across open fields with stiles.

- **Olive 1.4km**  
(approx 0.9 miles)
- **Red 2km**  
(approx 1.25 miles)
- **Green 2.4km**  
(approx 1.5 miles)
- **Yellow 2.75km**  
(approx 1.7 miles)
- **Blue\* 3.75km**  
(approx 2.3 miles)  
\*Not suitable for bikes, pushchairs or wheelchairs.

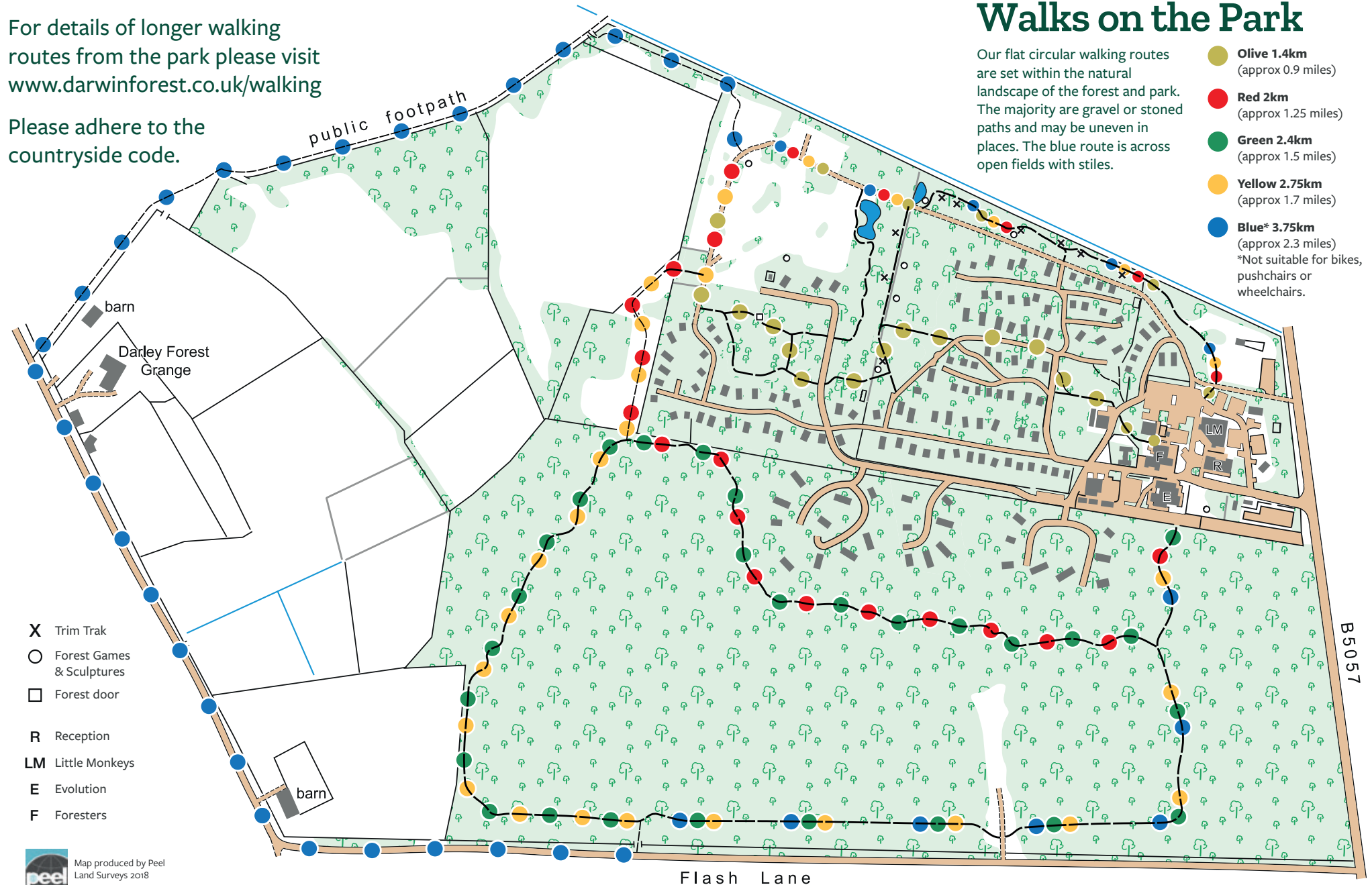

- X Trim Trak
- Forest Games & Sculptures
- Forest door
- R** Reception
- LM** Little Monkeys
- E** Evolution
- F** Foresters

Map produced by Peel Land Surveys 2018

Based upon the Ordnance Survey mapping with permission of the Controller of Her Majesty's Stationery Offer.  
© Crown Copyright. Licence No. 43423U.

© Copyright 2023 Darwin Forest

Download a map at  
[www.darwinforest.co.uk/park-maps](http://www.darwinforest.co.uk/park-maps)

**Darwin Forest**  
LUXURY LODGE HOLIDAYS